



THE REGISTRY
BAY AREA REAL ESTATE



Commercial

THE REGISTRY PRESENTS

MIDYEAR BROKER FORUM

Swift Realty to Close on \$197MM on Deals in San Jose and Pleasanton

POSTED ON APRIL 16, 2014 BY PUBLISHER IN COMMERCIAL, FINANCE, INDUSTRY NEWS



California Center in Pleasanton

By Jon Peterson

INDUSTRY News



Jamestown Sells Pacific Place in San Francisco to J.P. Morgan for \$415MM, \$965 per sq ft

JUNE 20, 2014



Embarcadero Capital Pays \$18.8MM for Office/R&D in Pleasanton

JUNE 18, 2014



Chatham Buys Into Strong Performing Silicon Valley Hotel Portfolio

JUNE 17, 2014



Rockwood Banking on Mountain View's Continued Appeal

JUNE 16, 2014



Swig and Project Frog Partnership Born Out of Need for Innovative, Sustainable Office Space

JUNE 16, 2014



Newsletter Sign Up

CURRENT ISSUE OF THE Q

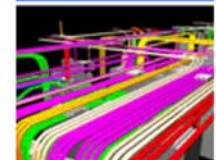

San Francisco-based Swift Realty Partners will be closing shortly on two office buildings acquisitions in the San Francisco Bay Area totaling more than \$197 million, according to sources with direct knowledge of the transactions. Swift Realty declined to comment when contacted for this story.

Related Articles

[Swift Realty Creates a \\$1B Investment Fund](#)

3 months ago

[Peatross: Ahead of the Curve](#)

3 months ago

The real estate manager will be paying around \$155 per square foot or \$159.7 million to acquire the 1.03 million square foot California Center in Pleasanton. It also will be paying \$125 per square foot or approximately \$37.5 million to purchase the 300,000 square foot Community Towers office building in downtown San Jose.

The property in San Jose should be acquired in the next 10 days, according to sources who are aware of the transaction. The seller of the property is Canadian Imperial Bank of Commerce. This asset was a REO. The bank had foreclosed on the property last year and cited too much debt on the asset as the primary reason for that decision. The lender is selling the property through HFF.

The San Jose property, which has occupancy of 94 percent, is located in the central business district of San Jose. A majority of the existing tenants in the property are at rental rates that are significantly below market, therefore the investment opportunity is to bring those close to market rates.

The California Center in Pleasanton is expected to close in the next 30 days. The purchase price that Swift is paying is well below replacement cost, now projected to be in excess of \$400 per square foot inclusive of land.

The property is currently owned by New York City-based Deutsche Asset & Wealth Management,

More BREAKING news

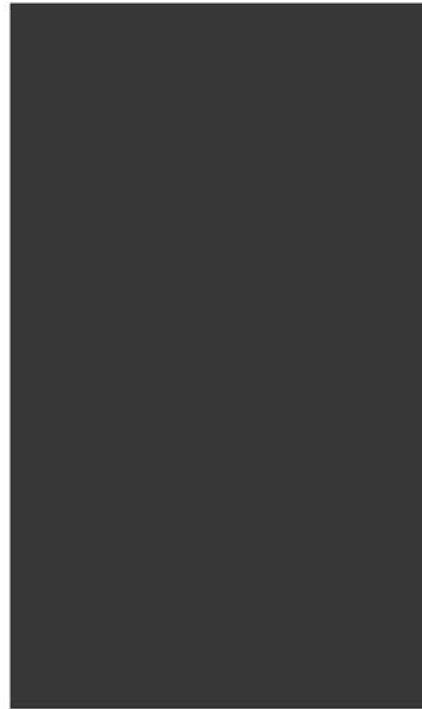

EXCLUSIVE INTERVIEW: JOHN KILROY



FEATURED ARTICLES



The Anatomy of a Tech Campus

May 28, 2014 | AEC, Commercial, Featured, Hot Lot, Technology

[Prev](#) [Next](#)



CRE TECH INTERSECT SAN FRANCISCO



CUSH & WAKE SILICON VALLEY BROKER MADNESS



PROJECT FROG & THE SWIG CO.



CONTRIBUTORS



Community Towers in San Jose

formerly known as RREEF. The listing agent on the property is JLL. Both the real estate investment company and the broker declined to comment for this article.

This office complex is located along Interstate 580 on Rosewood Drive. The 60.9-acre campus complex includes a total of eight buildings. It was completed in 1989 and was originally designed as AT&T's western regional headquarters.

The property has a significant vacancy issue. It now has over 700,000 square feet of vacancy making the occupancy in the complex at 30.8 percent, according to sources with direct knowledge of the complex. Existing tenants include Ross Dress for Less Inc., Gap Inc., Farmers Insurance and Zenith Insurance. Three of the buildings in the complex are vacant. Swift Realty figures this will give it a major re-leasing opportunity.

Swift Realty is also getting close to buying additional properties in the Bay Area. These are two small medical office buildings in Daly City and Foster City. These should be acquired over the next 30 days.

The real estate manager is buying all of these properties for its commingled fund, Swift Real Estate Partners Fund I. This investment fund will have a total capitalization of around \$1 billion in a combination of debt and equity.



Latest News Releases

Prologis to Develop Two Facilities Totaling 578,000 Square Feet in Europe
JUNE 23, 2014

Marcus & Millichap Arranges the Sale of a Four-Unit Apartment
JUNE 20, 2014

Quanta Computer Expands into Additional ±125,501 SF in Fremont
JUNE 20, 2014

Marcus & Millichap Arranges the Sale of a 28-Unit Apartment Building
JUNE 19, 2014

Marcus & Millichap Arranges the Sale of a 4,320 SF Office Building
JUNE 19, 2014

Jamestown Sells Pacific Place, a 430,000-Square-Foot Mixed-Use, LEED-Certified Property in Downtown San Francisco
JUNE 19, 2014

Marcus & Millichap Arranges the Sale of a 6-Unit Apartment Building
JUNE 19, 2014

Protesting Google's Buses is Insane
JUNE 19, 2014

Have You Registered Your Property?
JUNE 10, 2014

McNellis: House of Tax Breaks
MAY 30, 2014

McNellis on Crimeless Victims & Tyranny in Palo Alto
APRIL 16, 2014

The Foreclosure Crisis and Legal Change
MARCH 27, 2014



Industry Events

JUN
23
Mon

10:00 am - View Details
NAIOP San Francisco Bay Area – Ninth Annual Golf Tournament

The investment fund has a value-added strategy focused on a combination of office buildings and industrial properties on the West Coast. Its targeted markets are the San Francisco Bay Area, Los Angeles, Portland and Seattle. The targeted returns for the fund are a high-teens leveraged IRR.

Email and/or Print article:



Tagged Bay Area, California Center, Canadian Imperial Bank of Commerce, Community Towers, Daly City, Deutsche Asset & Wealth Management, Foster City, HFF, JLL, Pleasanton, RREEF, San Francisco, San Jose, Swift Realty Partners

Related



Swift Realty Creates a \$1B Investment Fund



Peatross: Ahead of the Curve



Swift Realty Pays \$129/SF for San Jose Buildings

Powered by

Socialize!

Like 3

Tweet 9

g+1 0

JUN
24
Tue

12:00 pm - View Details
SMPS East Bay - CHAT

JUN
25
Wed

5:00 pm - View Details
IFMA Silicon Valley - Mid-Year CRE Review and Liquid Space

JUN
26
Thu

5:30 pm - View Details
CREW East Bay/San Francisco - Gallery Tour and Wine Tasting

5:30 pm - View Details
Mohawk Group - Design Studio Opening

JUN
30
Mon

(all-day) - View Details
CCIM Northern California - Commercial Real Estate Golf Tournament

10:00 am - View Details
IREM San Francisco -16th Annual Golf Tournament

[Subscribe](#)

[View Calendar](#)

Share 2



THE REGISTRY

BAY AREA REAL ESTATE

The Registry is an integrated Bay Area real estate news company. We provide broad and relevant industry coverage focusing on analysis, information gathering and breaking news in the real estate and related sectors.

CURRENT ISSUE



SOCIALIZE



Search this site

LINKS

- [Home](#)
- [Current Issue](#)
- [Advertising](#)
- [About Us](#)
- [Contact Us](#)

© 2007 - 2014 Mighty Dot Media, Inc. All rights reserved.